

Data sheet

Commercial Art.No.: 99.411.0028.0

Cable assembly GST18i6KSBS 15HV 10SWPB

gesis® Extension cable female - male; length: 1 m; type GST18i6; 6-pole; Code 1;
250/400 V / 20 A; colour of coding: black with black strain relief; cable: S05HH-F
6G1,5 black



Commercial Art.No.	99.411.0028.0
EAN	4015573645356
Order Unit	1

Certificates / Approvals



Technical data

General

Rated current	16 A
Rated voltage	250 V
Rated impulse voltage	4 kV
Pollution degree	2
Mechanical coding	yes
Lockable	self-locking (unlocking by hand)
Color of coding/ contact carrier	pastel blue/black
Marking of poles	3, 2, 1, N, PE, L
Color of housing inclusive strain relief	black

Model

Nominal cross section conductor	1.5 mm ²
Degree of protection (IP)	IP20
Cable type	S05HH-F
Cable color	black
Cable diameter max.	11.2 mm
Version of cable	female - male
Type of cord set	Connecting cable with unlocking by hand
Version cable end 1	GST18i6 socket
Version cable end 2	GST18i6 plug

Material

Surface finish	Tin-plated
----------------	------------

halogen free	yes
Continuous temperature of cable	70 °C
Insulation components continuous temperature	100 °C
Fire load	0.983 kWh

Dimensions

Total length	1 m
--------------	-----

Classification

ECLASS 11	
ECLASS 8.1	27440604
ETIM 7.0	EC002587
ETIM 6.0	EC002587
ETIM 5.0	EC002587
ETIM 4.0	EC002587

Product compliance

ROHS conformity status	Compliant/Exempted
ROHS exceptions	III-6(c)
REACH-SVHC conformity status	Duty-To-Declare
REACH-SVHC substances	Lead
REACH-SVHC CAS numbers	7439-92-1

Accessories

Commercial Art.No.:	Article-type description:	Description:
05.564.5353.0	cover cap GST18I3/4/5 SW	Cover piece 12 pole black for female parts GST18i3-6
05.564.5353.2	cover cap GST18I3/4/5 WS	Cover piece 12 pole white for female parts GST18i3-6
06.562.0753.1	locking bracket GST18I6 SW	geis® locking clip for the flat GST18i6-system. To lock flying connections and distributors or PCB-parts with flat connectors. Colour: Black.

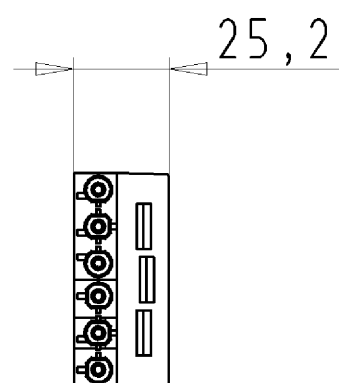
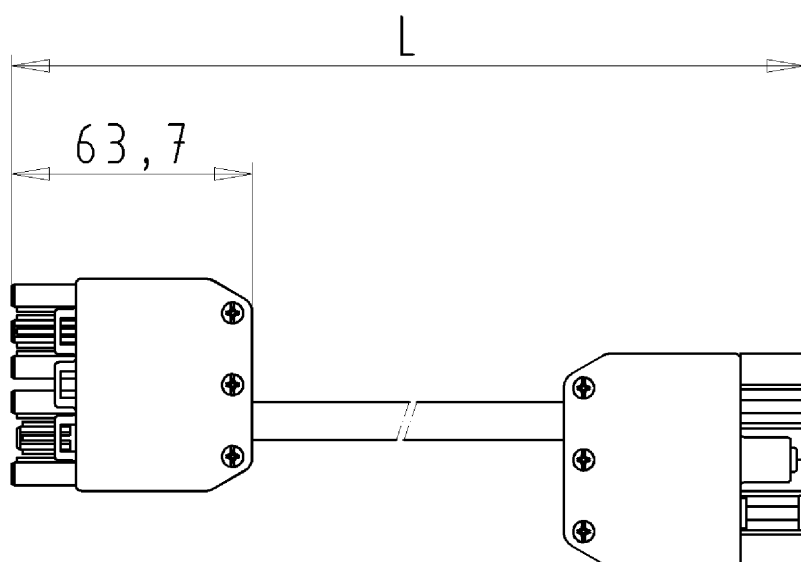

Konfekt. Leitung
 99.411.0028.0 10W
 22.04.2008 Weisensel F.
 M 1:2